

705 UNION STATION

705 5th Avenue South
Seattle, WA 98104





LOCATION. LOCATION. LOCATION.

Undeniably the most connected office location in Seattle, 705 Union Station sits at the center of one of the region's largest transit hubs with direct access to light rail, bus tunnel, train, street car, and freeways.

REGIONAL TRANSIT HUB.

- » International District Station: On-site Transit Hub with Link Light Rail and Metro Bus Tunnel
- » King Street Station: Adjacent, Amtrak and Sounder Access from Everett to Tacoma.
- » Seattle Streetcar: New Streetcar to First Hill stops in front of 705 Union Station
- » Freeways: Direct access to I-90 and I-5



On-Site Transit HUB - Link Light Rail



On-Site Transit HUB - Metro Buses



King Street Train Station

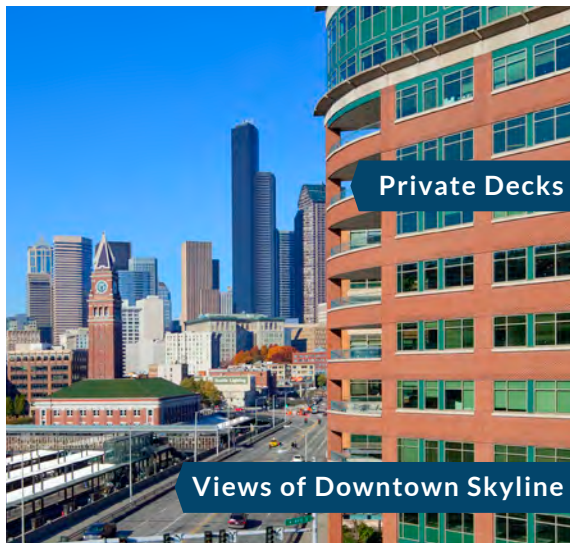

Private Decks

Views of Downtown Skyline



Views of Olympic Mountains, Mount Rainier and Elliott Bay

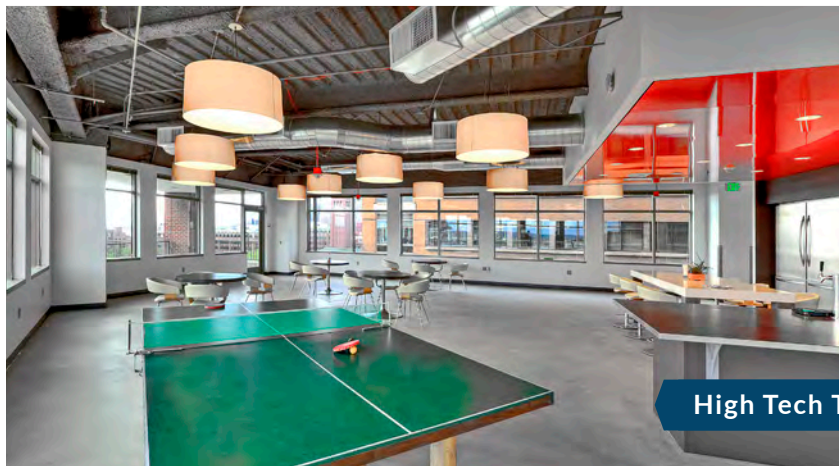

High Tech Tenant Spaces



On-Site Retail

FEATURES.

- » Unobstructed views of Elliott Bay, Olympic Mountains, Mt. Rainier and downtown Seattle
- » Efficient 24,100 SF floor plates
- » Private outdoor decks on each floor
- » New state-of-the-art conference center (seats 90)
- » New 6,500 SF fitness center
- » Abundant parking: 1/1,000 SF ratio
- » Expansive window line
- » Bike storage
- » LEED EB Gold and Energy Star rated



NEW Fitness Center



NEW Conference Room

AROUND THE NEIGHBORHOOD:

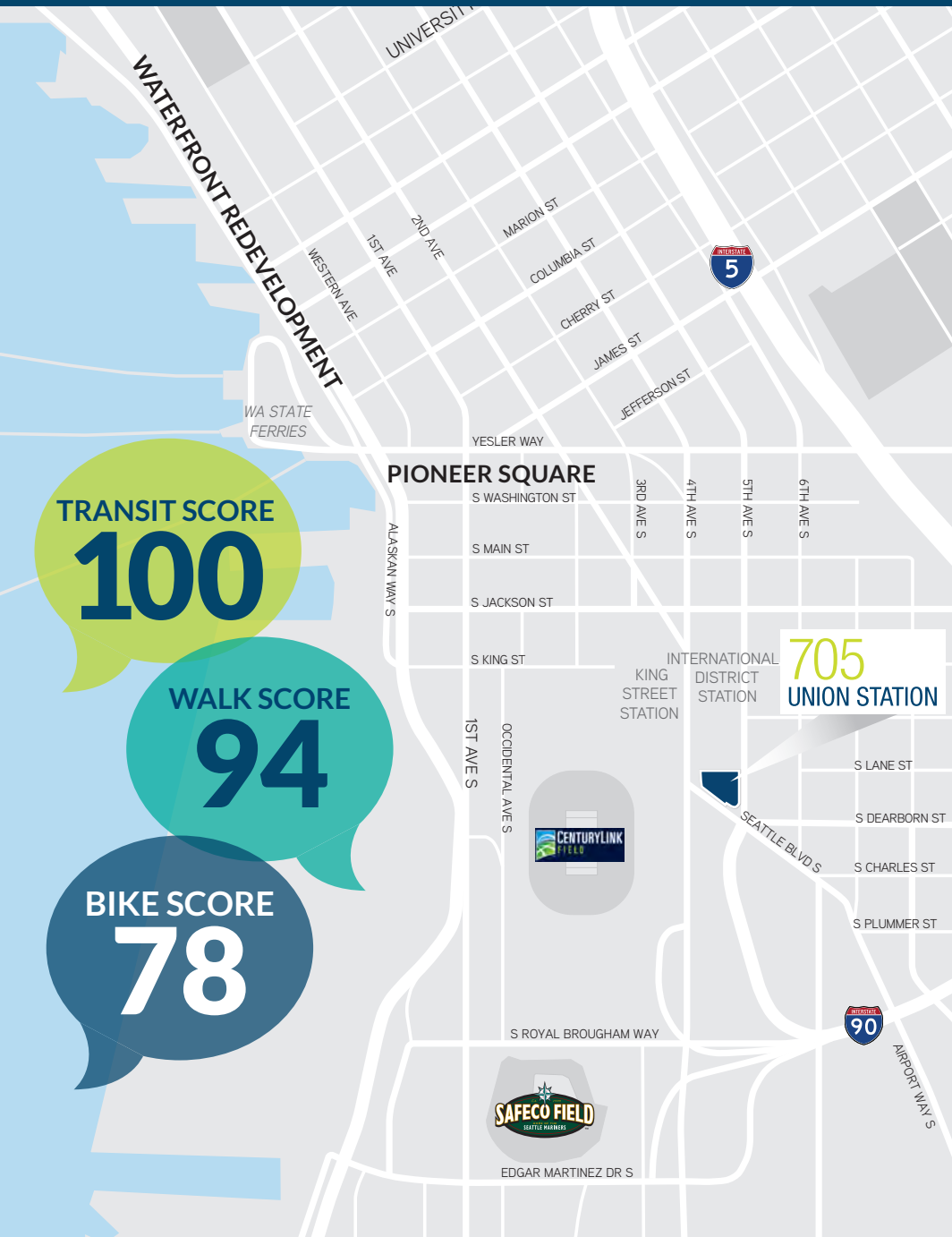

Seahawks CenturyLink Field



Local Bars and Restaurants

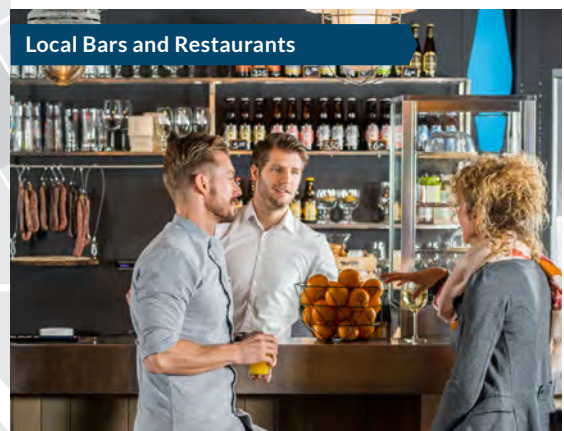

Pioneer Square Neighborhood



New Waterfront Redevelopment



WWW.705UNIONSTATION.COM

LAURA FORD

COLLIERS INTERNATIONAL

206 223 1423

laura.ford@colliers.com

GREG INGLIN

COLLIERS INTERNATIONAL

206 515 4491

greg.inglin@colliers.com

UNICO

Colliers
INTERNATIONAL